

Directions and Messages

Time : 1 hour 30 min.

Section 1 (1 hour)

Reading Comprehension

Read the passage below and answer the questions that follow.

The New School

'Good morning, girls and boys. Welcome to Sekolah Menengah Bistari. As you probably know, this is a very large school. So, before I take you around the school, let's take a look at the map of the school.'

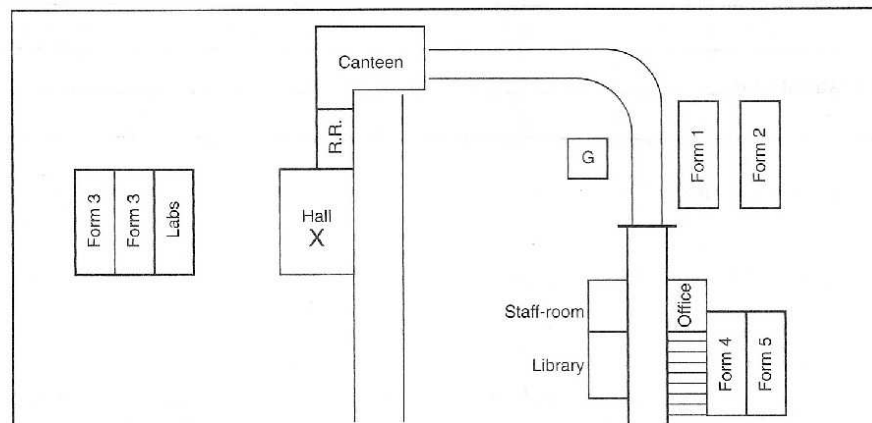

'We are now here, in the hall. When you leave the hall, turn left. The first room you will pass on your left is the Resource Room. Further down, at the end of the corridor, is the canteen.'

'In front of the canteen, is a small path. If you go along the path, it will take you to the Form One and Form Two blocks. These blocks are on your left. The Form Two block is behind the Form One block. The gymnasium is directly opposite the Form One block.'

'If you walk past the gymnasium, you come to a corridor. You will see the office on your left and the staff-room on your right, opposite the office next to the staff-room is the library. There is a staircase, next to the office, which leads up to the Form Four and Form Five classrooms.'

'Well, have you any questions?' asked Mrs Lee.

'Mrs Lee, what is that big building we see on the left of this hall where we are?' asked Su Min.

'Oh yes, I almost forgot,' answered Mrs Lee, 'that is where the Science Labs are.'

- 1 The main purpose of Mrs Lee's speech was to
- | | |
|---|--|
| <p>A help the students to like their new school</p> <p>B give the students directions to their classrooms</p> | <p>C help the new students find their way around the school</p> <p>D tell the new students that Sekolah Bistari is a very big school</p> |
|---|--|

- 2 Where were the students when they listened to Mrs Lee's speech?
 A At the school gate
 B In the school hall
 C In their classroom
 D Along the corridor
- 3 The Resource Room is
 A at the end of the corridor near the hall
 B between the canteen and the hall
 C on the right side of the hall
 D in front of the library
- 4 The _____ classrooms are nearest to the school gymnasium.

- A Form One
 B Form Two
 C Form Four
 D Form Three
- 5 What do you think happened after Mrs Lee's speech?
 A The students went back to their classrooms.
 B Mrs Lee took the students around the school.
 C The students had to draw a map of the school.
 D Mrs Lee went back to the staff room.

Grammar

A Prepositions, articles

*In the following sentences, the **prepositions** and **articles** have been used wrongly. Underline the **error** and write the correct answer in the blank.*

Example:

A canteen is opposite the staff room [The]

- 1 There is the staircase next to my classroom. [_____]
- 2 The library is on the end of the corridor, on the left. [_____]
- 3 Turn on the corner and you will see the school office and a big classroom. [_____]
- 4 Go straight for you see a red door. [_____]
- 5 I would like to invite you to my birthday party at Saturday morning. [_____]
- 6 The party ended till midnight. [_____]
- 7 I have not been feeling well on the past few days. [_____]
- 8 I received your message at Tuesday. [_____]
- 9 Walk on the corridor and turn left at the end. [_____]
- 10 Please meet me at a front school gate after school today. [_____]

B Rational Cloze

Read the following letters and choose from A, B, C or D to complete each blank.

Salmiah,

Did you know that the English Language Society is going to (1) actors and actresses for their latest play, 'Romeo and Juliet'? You (2) interested in acting, aren't you? Well, this (3) a good chance for you to try your luck. You may even get to act (4) Juliet, the heroine.

If you're interested, you have to be at (5) school hall at 2.30 p.m.

Best of luck!

Lee Ling

Lee Ling,

Thank you for your letter. Yes, it's my dream to become a famous actress (6) film-star. But right now, I have a terrible sore-throat. That's why I have been absent from school for the (7) two days. I have been drinking a lot of water and honey. Besides that, I have to (8) a horrible medicine that tastes very bitter. But my throat is (9) very painful.

Why don't you give it a try? I think you can be a very good actress. Go for it, Lee Ling!

All the very (10) !

Salmiah

- | | | | |
|------------|------------|----------|-----------|
| 1 A choose | B choosing | C choice | D chooses |
| 2 A is | B are | C were | D was |
| 3 A has | B had | C is | D are |
| 4 A as | B for | C like | D by |
| 5 A that | B an | C the | D a |
| 6 A also | B but | C or | D too |
| 7 A passed | B pass | C passes | D past |
| 8 A taking | B take | C taken | D took |
| 9 A still | B too | C also | D not |
| 10 A lucky | B luck | C good | D best |

Language Forms and Functions

Complete the conversation according to each of the underlined functions by selecting the **best** answer from the options **A, B, C** or **D**.

- Mrs Wong : I think I've lost my way.
To ask for directions _____ (1)
- Mrs Lim : Yes, of course. Just go straight along this corridor.
To direct _____ (2)
- Mrs Wong : Thank you very much.
Mrs Lim : Do you have a child studying here?
Mrs Wong : Yes, I'm Edward Wong's mother. He's in Form 1K.
Mrs Lim : I'm glad to meet you, Mrs Wong.
To introduce _____ (3)
- Mrs Wong : Edward says you have been very kind to him. He's very happy that you have chosen him to be the class monitor.
Mrs Lim : Well, Edward has carried out all his duties very well.
After you have been to the office,
To invite _____ (4)
- Mrs Wong : Thank you. I'd love to know how Edward is doing in school.

1 To ask for directions

- A Could you tell me where the office is?
- B Is the office far away from here?
- C Where is my son, Edward?
- D You could help me?

2 To direct

- A I can direct you.
- B It's not very far from here.
- C It's at the end, on your left.
- D I'm sure you can find the office.

3 To introduce

- A I'm Mrs Lim, his Form-teacher.
- B You have to introduce yourself.
- C Can you please introduce yourself?
- D I'm very happy to be your son's teacher.

4 To invite

- A you have to come to the staff-room.
- B the other teachers want to meet you.
- C I want you to come to meet the other teachers.
- D would you like to come to the staff-room and meet his other teachers?

Vocabulary

Choose the correct answer from **A, B, C** or **D** to show the opposite of the underlined word in each sentence. The word chosen must fit in the sentence grammatically.

- 1 My classroom is the last room along this corridor.
A first C third
B end D middle

- 2 I hope I have not come too late.
A early C in time
B lately D punctual

3 At the top of the stairs, you will see an arrow pointing left.

- A middle
- B bottom
- C roof
- D side

- C continue
- D cancelled

5 It is difficult to find your way in this school.

- A wonderful
- B easy
- C impossible
- D hard

4 The meeting will end at 3 p.m.

- A start
- B finish

Section 2 (30 minutes)

Writing

1 Write 4 sentences based on the notes given on how to get to the library:

(a) —straight—corridor

(b) —pass—office—left—staircase—on—right

(c) —up the staircase—right

(d) —past three or four classrooms—see—library—left

2 Complete the reply to the following invitation:

Selvi,

Please come to my house on Saturday at 4.00 p.m. I am having a party for all our old class-mates.

May Ling

May Ling,

Thank you for your invitation. Of course I'll come _____

I am sure we'll _____

I can't wait for _____

Selvi